

LAMBOUNDS - Standard J Arm Upright Door System

UDS90 - 90 Degree Upright Door System

UDS130 - 130 Degree Upright Door System

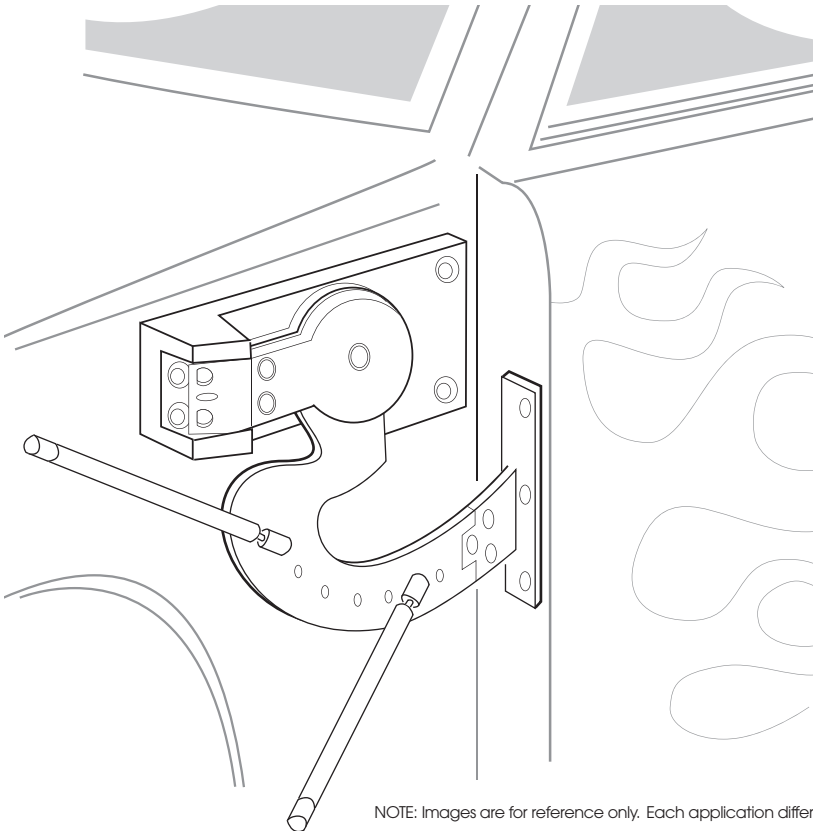

NOTE: Images are for reference only. Each application differs.

Close Up

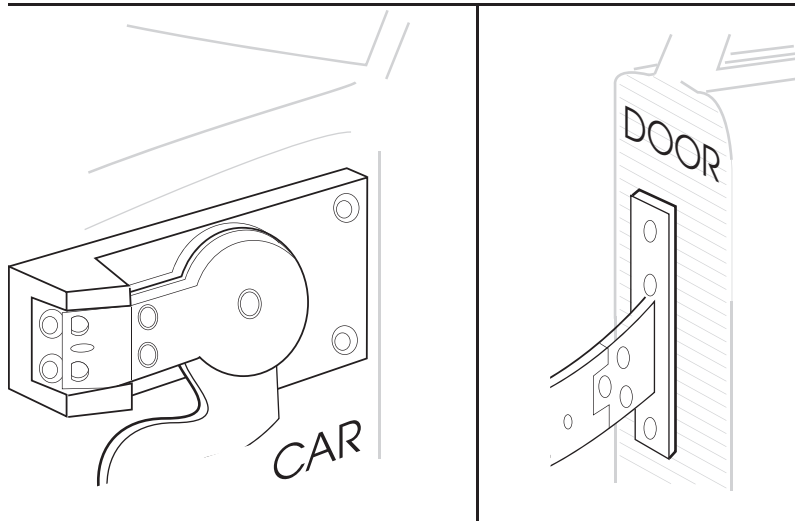

 **WARNING:** This is a universal kit, and may require custom modifications. AutoLoc™ highly recommends professional installation by a custom fabrication shop.

Installation

1. Disconnect battery.
2. Remove door panels and lower dash panels for easier access.
3. Remove fenders, and all necessary parts to remove them.
4. Remove door stop bar if applicable.
5. Remove all wiring running in to the door.
6. Close door and remove upper hinge
7. Test fit AutoLoc Lambo Hinge for correct placement on vehicle.
8. Be sure that the location the hinge will mount is flat, remove any unnecessary flanges or mounts.
NOTE: if cutting must be done be sure the chassis structure remains intact.
9. Hold the hinge in place and tack weld it in position, on chassis and door.
10. Be sure all measurements are correct before welding, or you may need to cut the welds and start over.
11. Remove lower hinge.
12. Open door and test the swinging motion
NOTE: use caution as there is nothing holding the door up.
13. Close door and replace fender to test the fit and motion.
14. Open door slowly, mark locations on fender that will need to be rolled or cut away, fender flange may need to be removed for more clearance.
15. Mark location on safety limit bar (on upright Door hinge) for correct outward movement.

USER GUIDE AND INSTALLATION MANUAL
UPRIGHT DOOR SYSTEM *Patent Pending

16. Extend all wiring running into the door, to allow for vertical travel, (solder all connections to prevent electrical problems) open and raise to measure for wire length. Remove wires from the loom and cut. Cut one wire at a time to prevent mistakes. Solder the appropriate extension lead and tape/heatshrink. Repeat with all wires. A longer wire loom may be needed.

17. Make all the proper adjustments, to allow for smooth opening and closing operation. See Fine Tuning section below.

18. With door open, attach strut to the hinge, locate and mark mounting position for ball stud on chassis.

19. Attach ball stud to chassis using either the supplied mount or fabricate one for your specific application.

20. Re-attach fender and all parts, that were removed and test motion.

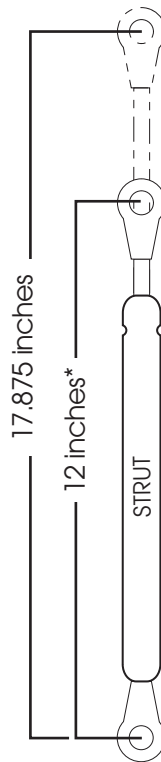

WARNING: Door's weight should not exceed 350lbs (158kg) for safe operation.

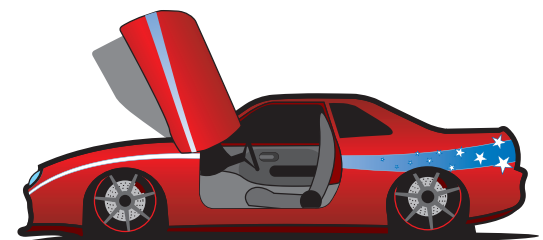
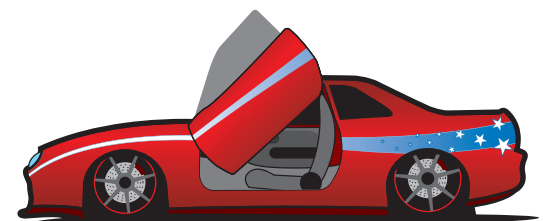
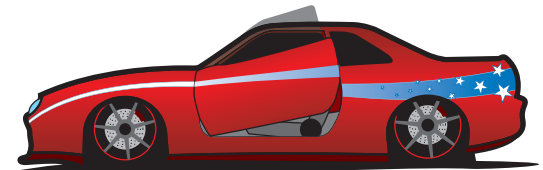

*Refers to distance between mounting holes when door is completely shut and latched.

Fine Tuning

Once you have the main components installed, it's time to do some fine tuning to insure proper operation. You have several adjustment points.

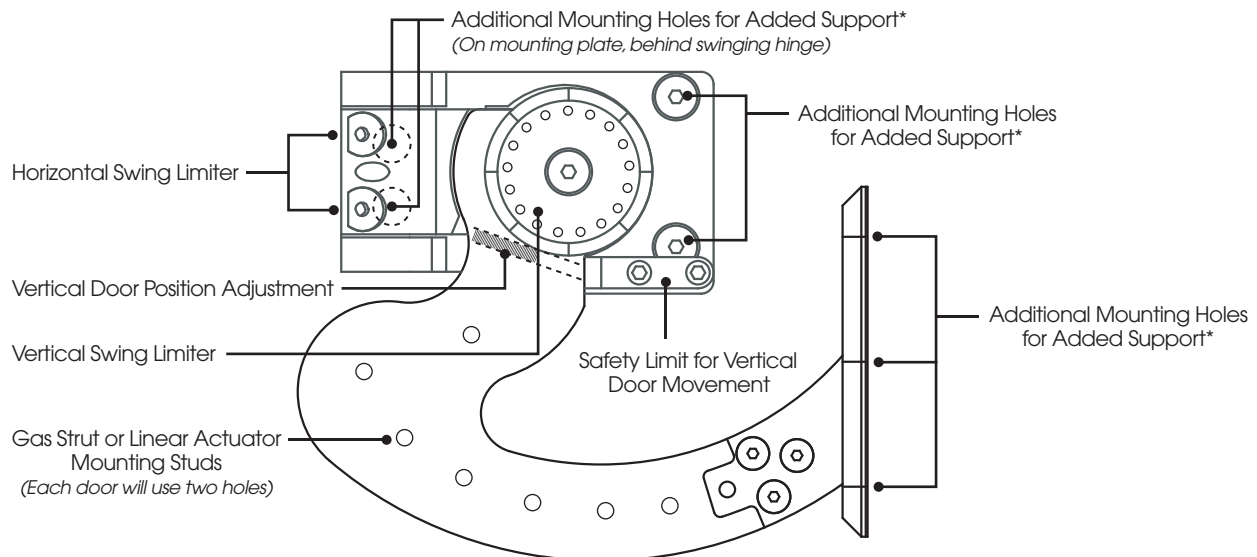

*NOTE: Kit must be welded for superior strength